

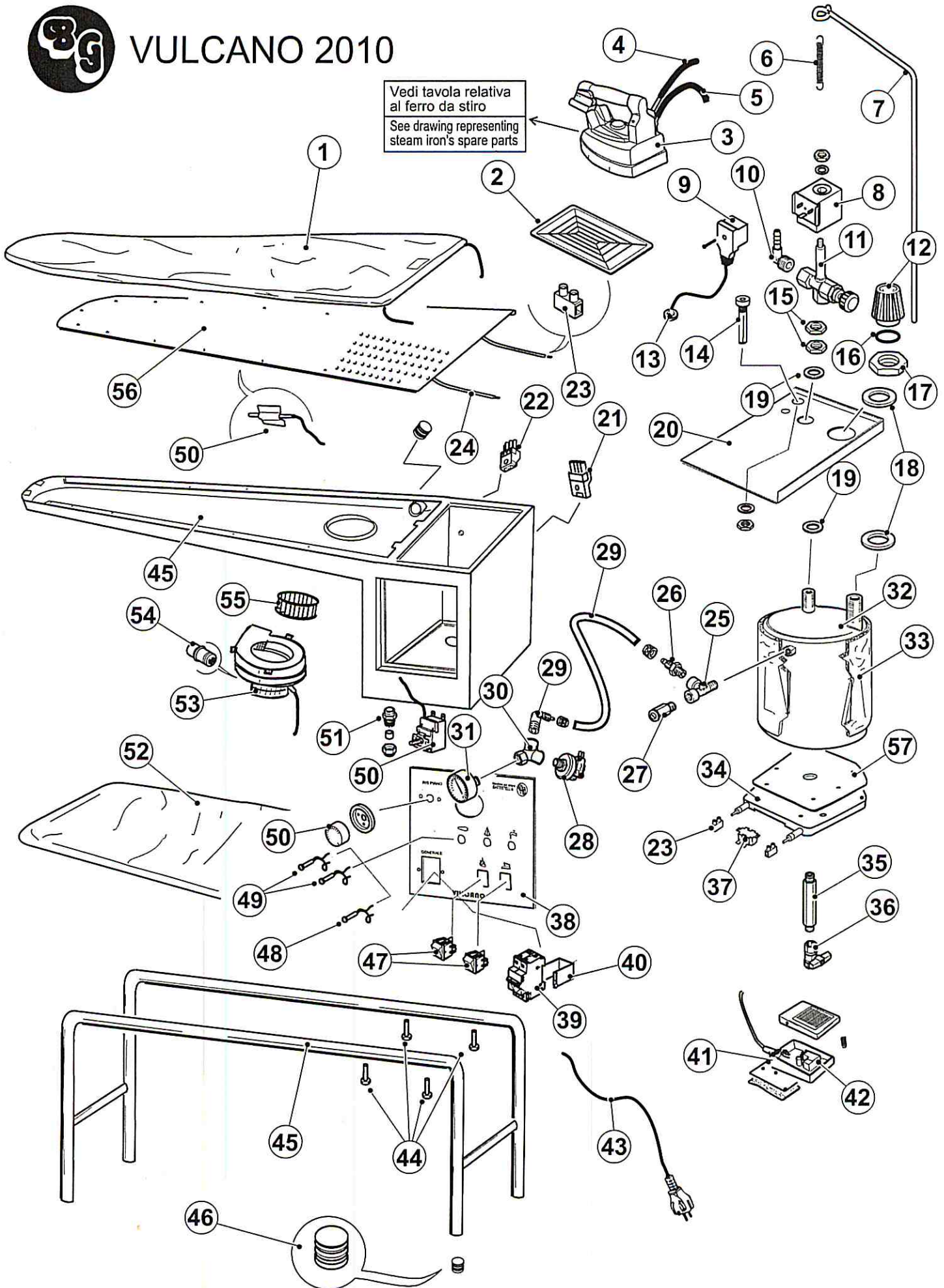

VULCANO 2010

Vedi tavola relativa
al ferro da stiro
See drawing representing
steam iron's spare parts



DESCRIZIONE COMPONENTI
 (COMPONENTS DESCRIPTION)

| POS. | Q.TA' | DESCRIZIONE | DESCRIPTION |
|------|-------|-----------------------------------|---|
| 1 | 1 | Prontotop imbottitura tavolo | Board Prontotop padding |
| 2 | 1 | Poggiaferro | Iron support |
| 3 | 1 | Ferro da stiro | Steam iron |
| 4 | 1 | Tubo vapore | Steam tube |
| 5 | 1 | Cavo di alimentazione ferro | Electric cable for iron |
| 6 | 1 | Molla reggifilo | Cable support spring |
| 7 | 1 | Antenna reggifilo | Cable support |
| 8 | 1 | Bobina | Coil |
| 9 | 1 | Connettore | Connector |
| 10 | 1 | Raccordo mandata vapore 1/4" | Steam feed joint 1/4" |
| 11 | 1 | Gruppo valvola | Valve group |
| 12 | 1 | Tappo valvola di sicurezza | Safety valve plug |
| 13 | 1 | Gommino | Rubber ring for wire |
| 14 | 1 | Porta antenna | Cable support holder |
| 15 | 3 | Dadi 1/4" | Nut 1/4" |
| 16 | 1 | Guarnizione OR tappo 3/4" | Plug OR gasket 3/4" |
| 17 | 1 | Dado 3/4" | Nut 3/4" |
| 18 | 2 | Rondelle 3/4" | Washers 3/4" |
| 19 | 2 | Rondelle 1/4" | Washers 1/4" |
| 20 | 1 | Coperchio | Cover |
| 21 | 1 | Presa Mazzeri per ferro | Mazzeri socket for iron |
| 22 | 1 | Presa Mazzeri per braccio | Mazzeri socket for arm |
| 23 | 2 | Morsetti | Clamps |
| 24 | 1 | Resistenza piano | Board resistance |
| 25 | 1 | Raccordo a "T" 1/8" | "T" Joint 1/8" |
| 26 | 1 | Raccordo 1/8" Ø6 | Joint 1/8" Ø6 |
| 27 | 1 | Valvola di sicurezza | Safety valve |
| 28 | 1 | Pressostato | Pressure switch |
| 29 | 1 | Raccordo curvo 1/8" Ø6 | Curved joint 1/8" Ø6 |
| 30 | 1 | Raccordo a "Y" 1/8" | "y" joint 1/8" |
| 31 | 1 | Manometro | Manometer |
| 32 | 1 | Caldaia | Boiler |
| 33 | 1 | Rivestimento caldaia | Boiler cover |
| 34 | 1 | Resistenza 2000W 230V | Resistance 2000W 230V |
| 35 | 1 | Raccordo di scarico | Exhaust joint |
| 36 | 1 | Rubinetto di scarico | Exhaust tap |
| 37 | 1 | Termostato 165° C + termofusibile | Thermostats 165° C + thermal fuse 298°C |
| 38 | 1 | Centralina | Switchboard |
| 39 | 1 | Interruttore generale | Main switch |
| 40 | 1 | Supporto interruttore generale | Main switch support |
| 41 | 1 | Pedaliera | Pedal |
| 42 | 1 | Micro pedaliera | Pedal micro switch |
| 43 | 1 | Cavo elettrico | Electric cable |
| 44 | 1 | Bulloni 8 MA | Bolts 8 MA |
| 45 | 1 | Telaio | Frame |
| 46 | 4 | Tappi in gomma | Rubber stoppers |
| 47 | 2 | Interruttori luminosi 16 A | Luminous switches 16 A |
| 48 | 1 | Lampadina spia arancione | Orange pilot lamp |
| 49 | 2 | Lampadine spia verde | Green pilot lamps |
| 50 | 1 | Termostato piano 90° C | Board thermostat 90° C |
| 51 | 1 | Pressacavo | Cable gland |
| 52 | 1 | Tela portabiancheria | Linen support cloth |
| 53 | 1 | Aspiratore 230 V | Aspirator 230 V |
| 54 | 1 | Condensatore | Capacitor |
| 55 | 1 | Ventola motore in alluminio | Aluminium motor fan |
| 56 | 1 | Piano stiro forato | Punched ironing board |
| 57 | 1 | Lamina per resistenza | Plate for resistance |