

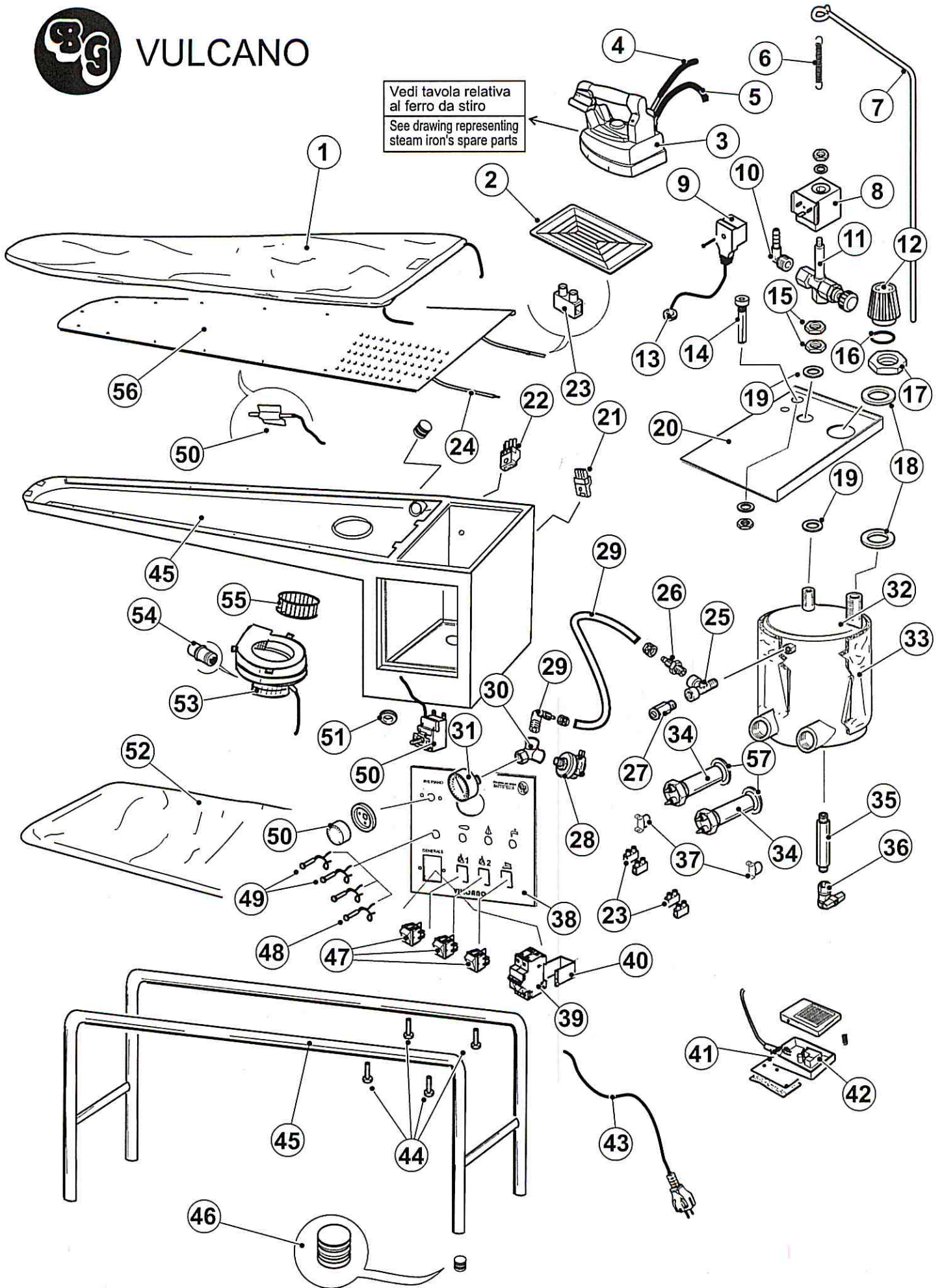

VULCANO

Vedi tavola relativa  
al ferro da stiro  
See drawing representing  
steam iron's spare parts

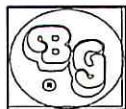



## DESCRIZIONE COMPONENTI (COMPONENTS DESCRIPTION)

| POS. | Q.TA' | DESCRIZIONE                    | DESCRIPTION             |
|------|-------|--------------------------------|-------------------------|
| 1    | 1     | Prontotop imbottitura tavolo   | Board Prontotop padding |
| 2    | 1     | Poggiaferro                    | Iron support            |
| 3    | 1     | Ferro da stiro                 | Steam iron              |
| 4    | 1     | Tubo vapore                    | Steam tube              |
| 5    | 1     | Cavo di alimentazione ferro    | Electric cable for iron |
| 6    | 1     | Molla reggifilo                | Cable support spring    |
| 7    | 1     | Antenna reggifilo              | Cable support           |
| 8    | 1     | Bobina                         | Coil                    |
| 9    | 1     | Connettore                     | Connector               |
| 10   | 1     | Raccordo mandata vapore 1/4"   | Steam feed joint 1/4"   |
| 11   | 1     | Gruppo valvola                 | Valve group             |
| 12   | 1     | Tappo valvola di sicurezza     | Safety valve plug       |
| 13   | 1     | Gommino                        | Rubber ring for wire    |
| 14   | 1     | Porta antenna                  | Cable support holder    |
| 15   | 2     | Dadi 1/4"                      | Nut 1/4"                |
| 16   | 1     | Guarnizione OR tappo 3/4"      | Plug OR gasket 3/4"     |
| 17   | 1     | Dado 3/4"                      | Nut 3/4"                |
| 18   | 2     | Rondelle 3/4"                  | Washers 3/4"            |
| 19   | 2     | Rondelle 1/4"                  | Washers 1/4"            |
| 20   | 1     | Coperchio                      | Cover                   |
| 21   | 1     | Presca Mazzeri per ferro       | Mazzeri socket for iron |
| 22   | 1     | Presca Mazzeri per braccio     | Mazzeri socket for arm  |
| 23   | 6     | Morsetti                       | Clamps                  |
| 24   | 1     | Resistenza piano               | Board resistance        |
| 25   | 1     | Raccordo a "T" 1/8"            | "T" Joint 1/8"          |
| 26   | 1     | Raccordo 1/8" Ø6               | Joint 1/8" Ø6           |
| 27   | 1     | Valvola di sicurezza           | Safety valve            |
| 28   | 1     | Pressostato                    | Pressure switch         |
| 29   | 1     | Raccordo curvo 1/8" Ø6         | Curved joint 1/8" Ø6    |
| 30   | 1     | Raccordo a "Y" 1/8"            | "Y" joint 1/8"          |
| 31   | 1     | Manometro                      | Manometer               |
| 32   | 1     | Caldaia                        | Boiler                  |
| 33   | 1     | Rivestimento caldaia           | Boiler cover            |
| 34   | 2     | Resistenze                     | Resistances             |
| 35   | 1     | Raccordo di scarico            | Exhaust joint           |
| 36   | 1     | Rubinetto di scarico           | Exhaust tap             |
| 37   | 2     | Termostati 150°C               | Thermostats 150° C      |
| 38   | 1     | Centralina                     | Switchboard             |
| 39   | 1     | Interruttore generale          | Main switch             |
| 40   | 1     | Supporto interruttore generale | Main switch support     |
| 41   | 1     | Pedaliere                      | Pedal                   |
| 42   | 1     | Micro pedaliere                | Pedal micro switch      |
| 43   | 1     | Cavo elettrico                 | Electric cable          |
| 44   | 1     | Bulloni 8 MA                   | Bolts 8 MA              |
| 45   | 1     | Telaio                         | Frame                   |
| 46   | 4     | Tappi in gomma                 | Rubber stoppers         |
| 47   | 3     | Interruttori luminosi 16 A     | Luminous switches 16 A  |
| 48   | 1     | Lampadina spia gialla          | Yellow pilot lamp       |
| 49   | 3     | Lampadine spia verde           | Green pilot lamps       |
| 50   | 1     | Termostato piano 90° C         | Board thermostat 90° C  |
| 51   | 1     | Gommino grande                 | Rubber ring for wire    |
| 52   | 1     | Tela portabiancheria           | Linen support cloth     |
| 53   | 1     | Aspiratore 220 V               | Aspirator 220 V         |
| 54   | 1     | Condensatore                   | Capacitor               |
| 55   | 1     | Ventola motore in alluminio    | Aluminium motor fan     |
| 56   | 1     | Piano stiro forato             | Punched ironing board   |
| 57   | 2     | Guarnizioni resistenze         | Gaskets for resistance  |